

# ROOM

WWW.ROOMONLINE.COM



---

## BOCCI 28 SERIES CHANDELIERS

AVAILABLE IN TWO STYLES: CLUSTERED OR TIERED PENDANTS WITH CLEAR AND VARIOUS COLOR GLOBES  
MADE OF MOUTH BLOWN GLASS WITH BRAIDED METAL CABLE (or flexible copper wire on select  
styles), WHITE AND BRUSHED NICKEL CANOPIES  
HEIGHT ADJUSTABLE UP TO 10' (STANDARD) AND 120' (CUSTOM)  
ITEM NO. L1119 (CLUSTERED); L1135 (TIERED)

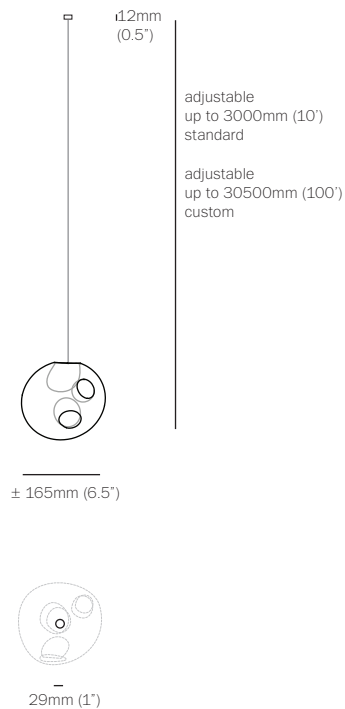
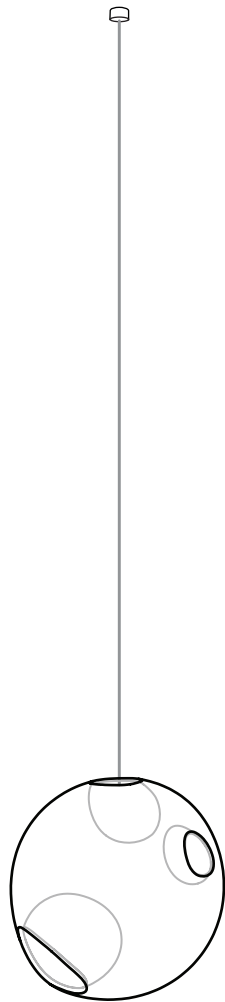

- PENDANTS: one
- CANOPY: mini canopy 29mm (1") diameter
- LAMPING: 20w xenon or 1.5w LED
- LENGTH OF COAX: 3000mm (10') standard / 30550mm (100') maximum
- INSTALLATION: strain relief (pendant light site adjustable)
- MATERIALS: blown glass, braided metal coaxial cable, electrical components, brushed nickel canopy
- WEIGHT: approximately 1.1kg (2.5lb)
- TRANSFORMERS: remote mounted (fixture does not hook directly to a junction box)  
1 transformer sent for every 3 pendants

#### DESCRIPTION

The 'm' designation in this 28 variant refers to the mini canopy size. The mini canopy is just over 1" (29mm) in diameter and 0.5" (13mm) deep, which creates a subtle profile that will essentially disappear into the application surface.

28 is an exploration of fabrication process which is part of Arbel's quest for specificity in manufacturing. Instead of designing form itself, here the intent was to design a system that produces form. Arbel developed a method that has loose parameters built into it which produce a different shape in every iteration of the fabrication procedure. Thus, every 28 made is formally different from any other 28 in existence.

#### APPLICATIONS

The 28.1m is recommended for new build applications where the intent is to create a cluster or cloud of 28 pendants in a room, without causing a negative visual impact on the ceiling plane.

Popular residential and commercial applications include clusters over tables in dining rooms and restaurants, accessory lighting in living rooms and baths, linear configurations over bars and kitchen islands, large clusters in foyers and lobbies in both private and public spaces, as well as single pendants as points of interest.

#### NOTES

- + Purchase replacement lamps online at [www.bocci.ca/lamps](http://www.bocci.ca/lamps)
- + Requires transformers to be remote mounted unless otherwise specified
- + Unless otherwise specified, a single class 2 transformer will be sent with every 3 pendants.

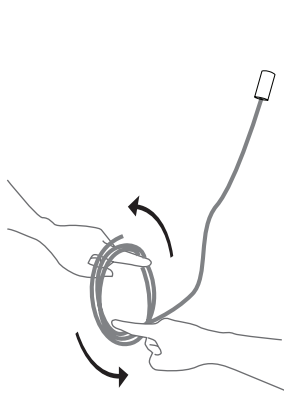

1

Very carefully uncoil the braided coaxial cable in a spool like manner. Insert your index fingers into opposite sides of the roll then rotate your fingers around each other to unroll the coaxial cable. Use patience: allow the cable to uncoil completely to avoid kinks.

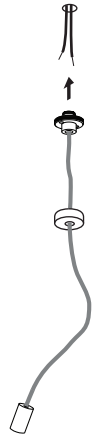

2

Drill a 9mm diameter hole in ceiling material. Pull low voltage house wire through the hole.

Note: This low voltage wire will run to a remote mounted transformer.

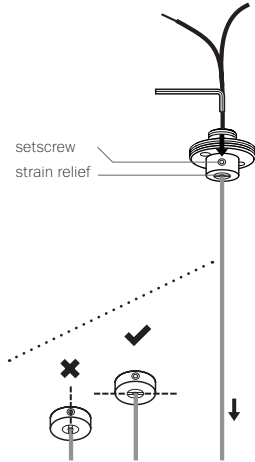

3

Determine the overall drop for the pendant fixture. Use the Allen key provided to loosen the setscrew in the canopy and gently feed the cable through the canopy until you have reached your desired drop length. Use Allen key to tighten the setscrew to hold the strain relief to secure the coaxial cable at its new length.

DO NOT OVERTIGHTEN.

Note: The strain relief is a black plastic collar around the coaxial cable. There is a single slot opening on the side of the strain relief component. It is essential that this opening is oriented at 90 degrees to set screw chamber. There can be no contact between the set screw and the cable.

- RISK OF ELECTRIC SHORT!

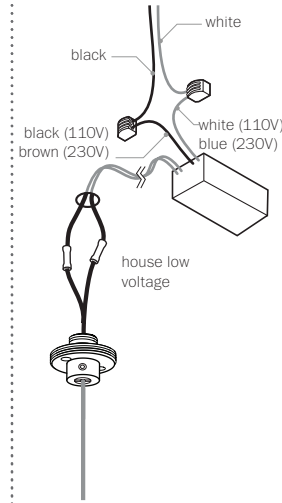

4

Connect the house wires to the coaxial cable using #16 butt splices (stagger the splices). Use raw butt splices and heat shrink to simplify the installation.

LED:  
Note: Insulated core is positive and braided exterior is negative.

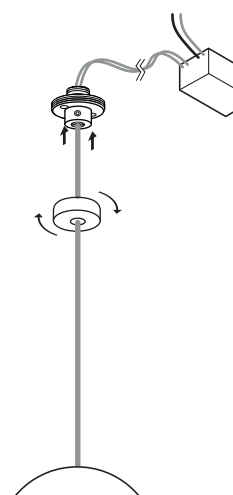

5

Affix mini-canopy to ceiling surface with fasteners provided. Twist the threaded canopy cover plate into place.

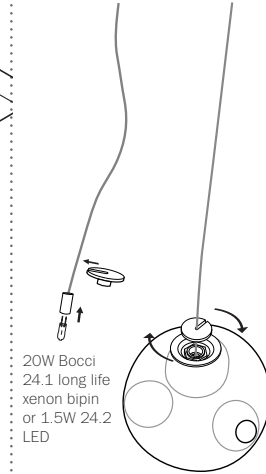

20W Bocci  
24.1 long life  
xenon bipin  
or 1.5W 24.2  
LED

6

Bocci 24.1.2 long life bipin xenon lamps included. Plug the lamp into the socket. Do not touch the lamp with your bare hands.

Remove the center cap from 28 pendant. Install 28 pendant by sliding the center cap onto the coaxial cable gently inserting the lamp into the pendant, and then tightening the center cap connection by hand.

Do not over tighten.

Remove the protective film from the center cap after assembly.

Note: when using a dimmer for xenon, use only low voltage electronic dimmer.

7

Clean fingerprints from glass surfaces.

Turn fixture on.

Purchase replacement lamps online at [www.bocci.ca/lamps](http://www.bocci.ca/lamps)

\*

For additional assistance, please contact Bocci:

**BOCCI** Vancouver  
info@bocci.ca  
www.bocci.ca

**BOCCI** Berlin  
europe@bocci.ca  
www.bocci.ca

Worldwide patents issued and pending.

Made in Vancouver, Canada

Approved to UL standards by CSA



28.1m

Design by Omer Arbel  
INSTALLATION INSTRUCTIONS

© 2013, Bocci Design and Manufacturing Inc. Any inquiries should be directed to the following email address: info@bocci.ca.

**BOCCI**